

Vertical Sheer Installation Instructions

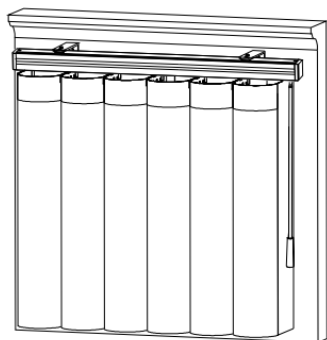

Vertical Sheer

Required Tools

- Drill
- Measuring Tape
- Screwdriver
- Level
- Pencil

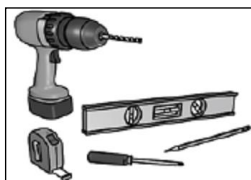

Components

Name	Drawing	Notes
L Bracket		L Bracket Set
C Clip		
Nut		
Bolt		
#8x1 1/4" Screw	 For installing L bracket	Screws for orders without plastic spacers
#8x2" Screw	 For installing L bracket	Screws for orders with 1 or 2 layers of plastic spacers
M3.8x63.5 mm Screw	 For installing L bracket	Screws for orders with 3 layers of plastic spacers
Plastic Spacer		Optional

Hardware Quantity

Headrail Width (R)	$R \leq 52.5"$	$52.5" < R \leq 89"$	$89" < R \leq 94.5"$	$94.5" < R \leq 125.625"$
L Bracket Set (L Bracket + C clip + Nut + Bolt)	2	3	4	6
#8x1 1/4" Screw (without spacer)	4	6	8	12
Optional: Plastic Spacer: 1 layer	2	3	4	6
Optional Plastic Spacer: 2 layers	4	6	8	12
#8x2" Screw (with 1 or 2 layers of spacers)	4	6	8	12
Optional Plastic Spacer: 3 layers	6	9	12	18
M3.8x63.5 Screw (with 3 layers of spacers)	4	6	8	12
C clip (Use on where 2 headrails meet for side by side shade)	1	1	1	1

Joint Headrails (SmartJoint)

- Joint headrails when width > 94.5":

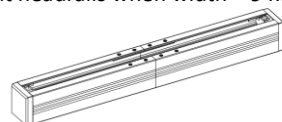

Please follow the below steps:

1. Assemble the top and bottom connectors to one headrail first.
2. Make sure the shafts are aligned (turning to the same side) and push the headrails together.
3. Place the small piece between the headrails to make sure the 2 headrails are aligned and then tighten the bolts.

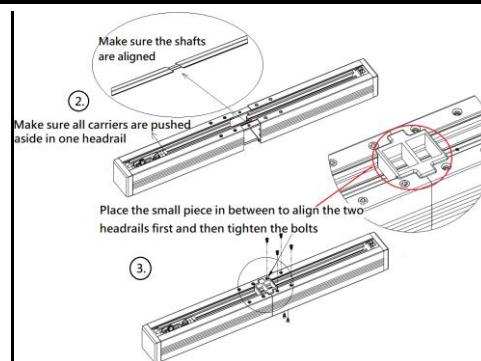
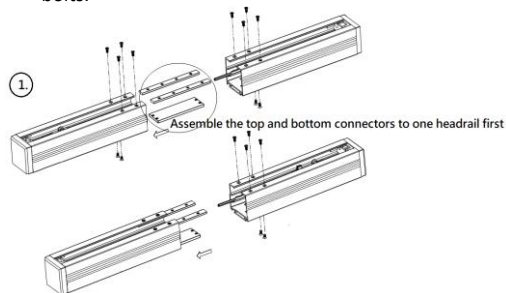

Installation

- L bracket placement

Headrail width (R)	L bracket placement	SmartJoint
$R \leq 40"$	$X=4"$	N
$40" < R \leq 94.448"$	$X=8"$	
$R > 94.448"$	2.5" from where the 2 rails joint together: $X=8"$	Y

W/O SmartJoint

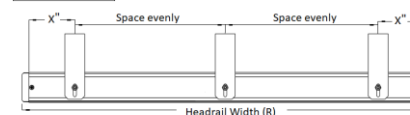

SmartJoint

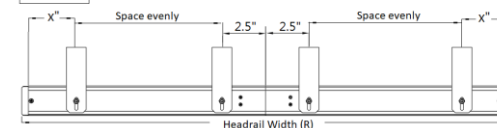

- Tighten the nut and bolt after the C clip has been adjusted to the position that best fits for your windows.

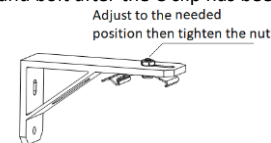

- Make sure that the distance from the top of the bracket to the edge of the window frame is at least 3" (see diagram below).

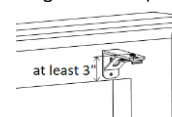

- Place brackets into position and mark where the screws will go. Secure the brackets into position using the screws provided.

If more brackets have been supplied, space them evenly between the first two brackets.

We recommend using a level to align brackets. Position the top front lip of the headrail into the C clip front lip, then push the headrail up at the back to click it into place as per step 2 in diagram below.

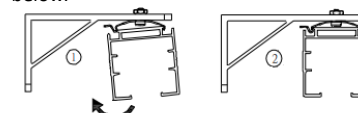

- For side by side shades, add a C clip where the two headrails meet.

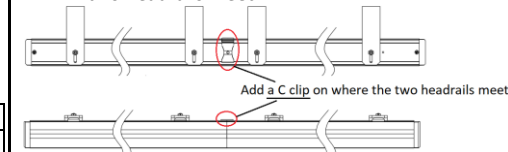

Fabric

- Assemble the fabric vanes

- Unroll the fabric and remove the vanes one by one from the top of the roll.
- The first top vane of the unrolled fabric goes to the left end.
- Fasten the fabric vanes to one another by clasping the male and female clips together, as per step 1 in the diagram below. Then push the clips up to the carriers, as per steps 2 & 3 in the diagram.

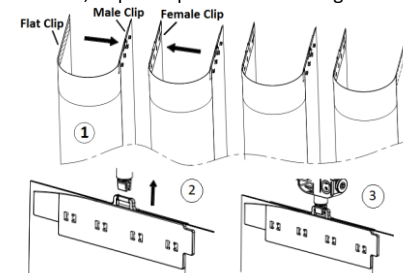

- Assemble the fabric vanes from the left to right. Repeat the steps in the diagram above to finish the installation.

N301084-D

Removal

● Remove the fabric vanes

Pull down the fabric clips from the carriers; then detach the male and female clips holding the vanes together.

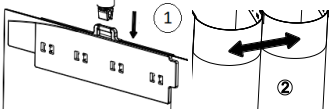

● Remove the headrail – Outside Mount

Insert flat screwdriver between the C clip and the headrail at the back. Tilt screwdriver forward until headrail loosens. Remove headrail from clip.

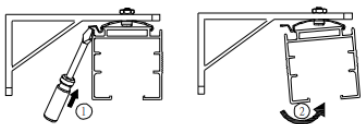

Operation Instructions

- To adjust the shade, rotate the wand. Turn it one way to open for sunlight, and the other way to close for privacy.

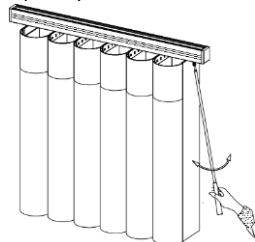

- Make sure the fabric vanes are in an open position when stacking the shade open or closed.

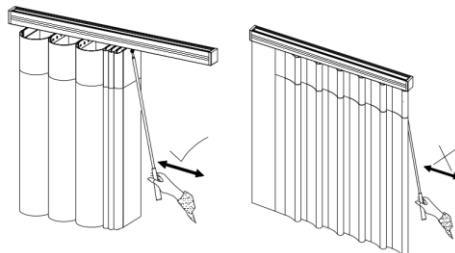

- Please note that the fabric vanes cannot close entirely when some vanes are stacked.

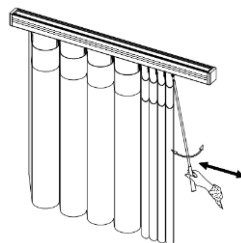

- If the fabric vanes don't move simultaneously when rotating the wand, please keep rotating the wand to one end until you hear the "click-click" sound and then rotate the opposite direction to another end until you hear the click sound again. Repeat this 2 times and if it's not back to normal, adjust the fabric clip to align with others manually.

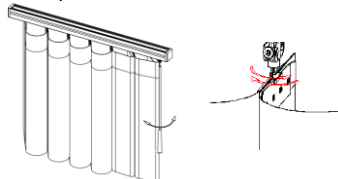

Maintenance

● Hand wash

1. Remove fabric vanes from the carrier. (Do not detach the fabric clips from the fabric vanes).
2. Fold the fabric vane carefully and put it in a container filled with water and laundry detergent.
3. Soak the fabric vane in water with laundry detergent for about 30 minutes and then rub the stain gently.
4. Soak the fabric in clean water for about 5 minutes and then clean out all the soap.
5. Shake out the fabric vane and then let stand until it stops dripping water. (Please be careful not to crease or wrinkle the fabric during this time).
6. Hang the fabric vanes back and keep them in open position (keep them in U shape). Leave them open to dry naturally.
7. If it's wrinkled after the fabrics are dry, steam it to eliminate the wrinkles. It's recommended that you save the paper tube that came with the fabric roll and place it behind the fabric vane for support while steaming. Fabric vane can be steamed on "Nylon" setting (around 200-220°F).

● Machine wash

1. Remove fabric vanes from the carrier. (Do not detach the fabric clips from the fabric vanes).
2. Roll each fabric vane from bottom to the top and then put one roll of fabric in each laundry bag.
3. Set the washing machine to a soft/gentle cycle. Use cold water with laundry detergent. Do not spin.
4. Take out the fabric roll from the laundry bag. Shake out the fabric vane and then let stand until it stops dripping water. (Please be careful not to crease or wrinkle the fabric during this time).
5. Hang the fabric vanes back and keep them in open position (keep them in U shape). Leave them open to dry naturally.
6. If it's wrinkled after the fabrics are dry, steam it to eliminate the wrinkles. It's recommended that you save the paper tube that came with the fabric roll and place it behind the fabric vane for support while steaming. Fabric vane can be steamed on "Nylon" setting (around 200-220°F).

Vertical Sheer Motorized System Installation Instructions

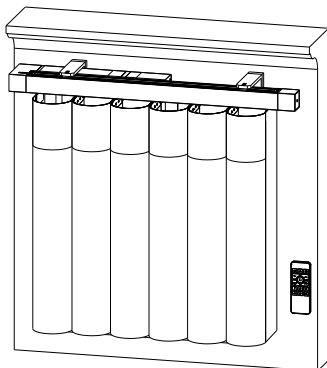

Motorized System Information

No.	Item	Specification
1	Power Source	MSD-B: Li-ion Battery Pack Input: 5-20V, 2A Max. Output: 14.4V, 3A Max.
2	Radio type	Proprietary 2.4G RF
3	Motor type	Brushed DC motor
4	Charge type	USB Type C charger
5	Charging Time	*3~5 hours: charging with fast charger that comply with PD3.0 and DP&DM fast charging protocols, with an output voltage of 5V~20V *5~9 hours: using normal 5V2A charger and charging cable (cable length: 3.25') *9.5~12.5 hours: using the charging kit ordered with the shade.
6	Charging Temperature	0°C/32°F ~ 45°C/113°F
7	Operating Temperature	0°C/32°F ~ 45°C/113°F
8	Relative Humidity	0% ~ 90% (Non-condensing)
9	Ave. Sound Level @1m	≤ 40 dB

FCC ID: Q3V-MSDB
IC ID: 28542-MSDB
CAN ICES-003 (B) / NMB-003(B)



Safety Statement

Federal Communication Commission Interference

Statement This device complies with Part 15 of the FCC Rules. Operation is subject to the following two conditions:

- (1) This device may not cause harmful interference, and
- (2) this device must accept any interference received, including interference that may cause undesired operation.

This equipment has been tested and found to comply with the limits for a Class B digital device, pursuant to Part 15 of the FCC Rules. These limits are designed to provide reasonable protection against harmful interference in a residential installation. This equipment generates, uses and can radiate radio frequency energy and, if not installed and used in accordance with the instructions, may cause harmful interference to radio communications. However, there is no guarantee that interference will not occur in a particular installation. If this equipment does cause harmful interference to radio or television reception, which can be determined by turning the equipment off and on, the user is encouraged to try to correct the interference by one of the following measures:

- Reorient or relocate the receiving antenna
- Increase the separation between the equipment and

receiver.

- Connect the equipment into an outlet on a circuit different from that to which the receiver is connected.
- Consult the dealer or an experienced radio/TV technician

for help. FCC Caution: Any changes or modifications not expressly approved by the party responsible for compliance could void the user's authority to operate this equipment.

FCC Caution: Any changes or modifications not expressly approved by the party responsible for compliance could void the user's authority to operate this equipment. This transmitter must not be co-located or operating in conjunction with any other antenna or transmitter.

Industry Canada Equipment Standard for Digital Equipment (ICES) –Canada

This Class B digital apparatus complies with Canadian ICES-003. Cet appareil numérique de la classe B est conforme à la norme NMB-003 du Canada. CAN ICES-3 (B)/NMB-3(B)

Innovation, Science and Economic Development Canada(ISED) Compliance Statement

This device complies with ISED's licence-exempt RSS standard(s). Operation is subject to the following two

conditions: (1) this device may not cause interference, and (2) this device must accept any interference, including interference that may cause undesired operation of the device.

Le présent appareil est conforme aux CNR d'ISED applicables aux appareils radio exempts de licence. L'exploitation est autorisée aux deux conditions suivantes : (1) le dispositif ne doit pas produire de brouillage préjudiciable, et (2) ce dispositif doit accepter tout brouillage reçu, y compris un brouillage susceptible de provoquer un fonctionnement indésirable.

Radiation Exposure Statement: This equipment complies with FCC/ISED radiation exposure limits set forth for an uncontrolled environment. This equipment should be installed and operated with greater than 20cm between the radiator & your body.

Déclaration d'exposition aux radiations: Cet équipement est conforme aux limites d'exposition aux rayonnements FCC/ISED établies pour un environnement non contrôlé. Cet équipement doit être installé et utilisé à plus de 20cm entre le radiateur et votre corps.

Safety Precautions

Thank you for your purchase. Please review the instructions carefully before using the product, and save these instructions for future consultation.

- The characteristics of the driven part must be compatible with the rated load and rated operating time.

The mass and the dimension of the driven part shall be compatible with the rated torque and rated operating time.

The drive shall be disconnected from its power source during cleaning, maintenance and when replacing parts.

Do NOT disassemble the products or any of their components. They do not contain serviceable parts. Servicing of these products should be referred to qualified personnel.

Do NOT operate the product with wet hands to avoid risk of electrical shock. The product needs to be powered off and disconnected from its power source during cleaning, maintenance and/or replacing parts. The battery contains flammable materials such as organic solvents.

Please recharge the batteries every 3-5 months to ensure optimal performance of batteries.

Product operation is intended for temperatures between 0°C/32°F ~ 45°C/113°F.

Please note that the limited warranty will be voided if the product is modified, dismantled or used in any manner other than its intended purpose.

The accessories, including adapter and remote are designed to be used with our motorized shades. Do NOT use them for any other purpose.

Please make sure the shade route is clear when operating to avoid danger or damage.

In order to improve the user experience and functionality, the firmware and software of this product will automatically update from time to time. The appliance is not intended for use by persons (including children) with reduced physical, sensory or mental capabilities, or lack of experience and knowledge, unless they have been given supervision or instruction concerning use of the appliance by a person responsible for their safety. Children should be supervised to ensure that they do not play with the appliance.

If the supply cord is damaged, it must be replaced by the manufacturer, its service agent or similarly qualified persons in order to avoid a hazard.

Keep remote controls away from children.

Frequently examine the installation for imbalance and signs of wear or damage to cables springs and fixings. Do not use if repair or adjustment is necessary.

- Please charge the shade before use.
- Please DO NOT bend or twist the charging cord to avoid product damage or raise safety concerns.

Required Tools



- Drill
- Measuring Tape
- Screwdriver
- Level
- Pencil
- Hexagon Socket



Components

Name	Drawing	Remark
L Bracket		Outside Mount
C Clip		Outside Mount
Nut		For Installing C clip onto the bracket
Bolt		
Hex head screw		Outside Mount For installing L brackets

N301084-D

Trapezoid Cover Panel		Optional For SmartJoint
Remote Control		Optional

Bracket Placement

Use a double-slot bracket on the motor side. Ensure center brackets are evenly spaced, and refer to the table below for proper bracket distances.

	Without SmartJoint	With SmartJoint
Rail Length ≤ 40	4.25" from edge	
$40 < \text{Rail Length}$	8" from edge	2.5" from joint

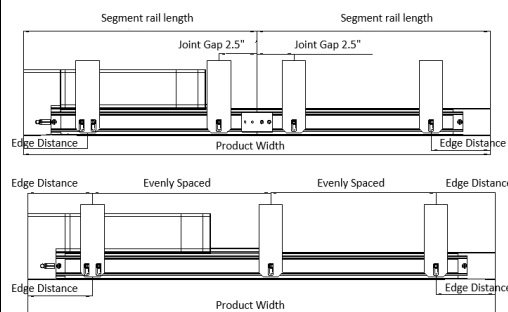

Assembly

- Do not remove the motor or battery during the assembly process.
- Left-Right Stack Configuration

Refer to the diagram below for the unboxing layout of a non-joint headrail:

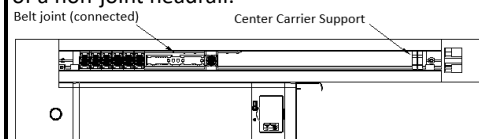

Refer to the diagram below for the unboxing layout of a SmartJoint headrail:

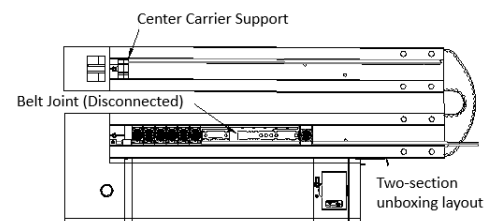

- Center-opening**
Refer to the diagram below for the unboxing layout of a non-joint headrail:

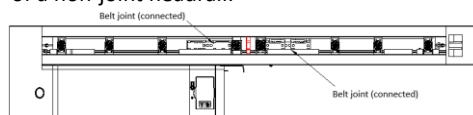

Refer to the diagram below for the unboxing layout of a SmartJoint headrail:

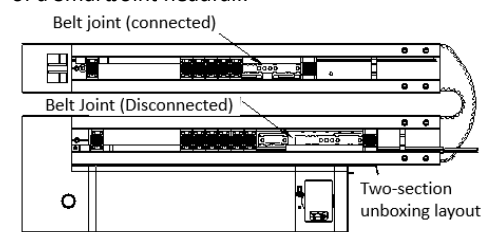

Note: When using a SmartJoint system, only the belt connector on the motor side is detached.

- Headrail Connection:**
For center-opening products using a two-piece SmartJoint headrail, position the central hub within 100mm of the joint connection point before installation. For a three-piece SmartJoint headrail, align the central hub within 100mm of the center section's midpoint, as shown in the diagram.

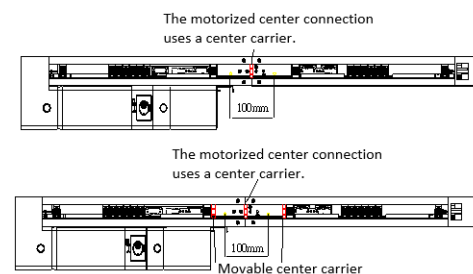

First, secure the connector to one side of the headrail. Then insert the hexagonal aluminum shaft into the corresponding shaft port on the

opposite section, ensuring the beveled edge is properly aligned. While inserting the shaft, simultaneously slide the steel plate into the belt clip, making sure it engages with at least two belt teeth. Finally, center the joint bracket at the headrail connection point and tighten the upper and lower bolts to secure.

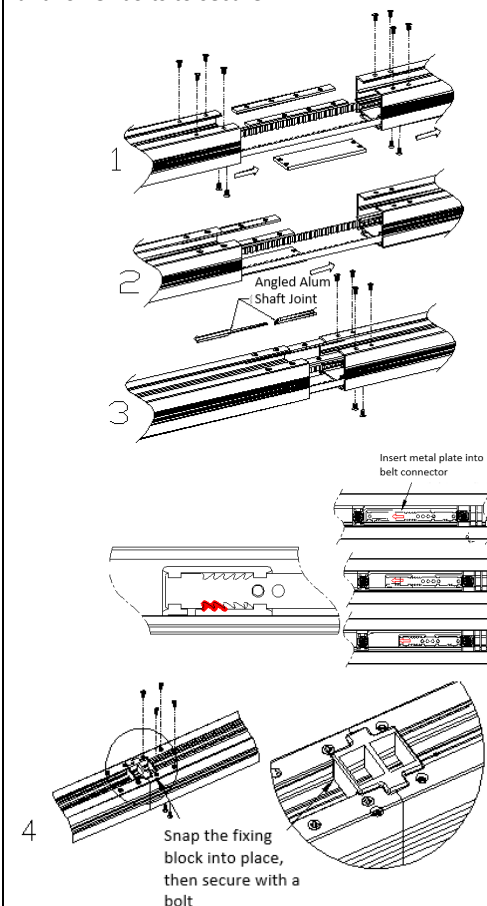

After assembling the headrail (jointed or non-jointed), manually slide the connecting steel plate back and forth to confirm smooth movement. Once verified, push the carriage assembly fully toward the stacking side.

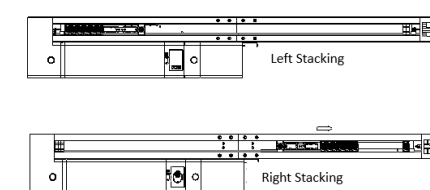

Powering On the Motor

- Press and hold the button located at the bottom of the motor for 3 seconds. The LED indicator will flash blue and emit two beeps, indicating successful startup.

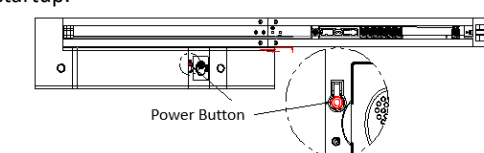

- Attach the charging rod to the lithium battery.
- Affix the mounting base to the main drive unit.
- Position the cable clip so that it aligns horizontally with the battery's Type-C port, centered on the back of the battery.

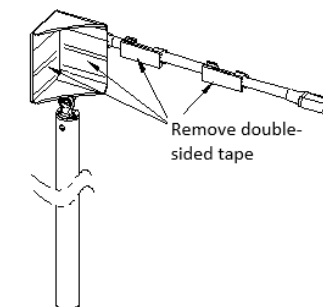

After powering on the motor, test functionality by pressing the open (🔼) and close (🔽) icons on the remote. Once confirmed, return the shade to its default position. Then, if applicable, install the charging rod, secure the headrail to the wall, and hang the fabric vanes

Headrail Installation

Secure the L-shaped brackets using M4×48mm hex head screws, ensuring all brackets are aligned horizontally. Each bracket requires two screws. After positioning the C-clips within the elongated slot of the L-bracket, tighten the bolts to secure them in place.

N301084-D

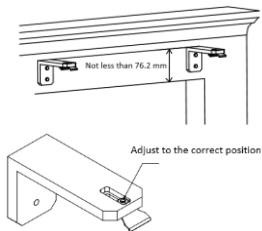

Ensure the tilt wand is correctly positioned left or right as needed. Hook the front upper rib of the headrail into the forward-facing hook of the mounting bracket (see Figure 1).

Then rotate the headrail from below toward the back and up, so the rear bottom flange locks into the rear lower slot of the bracket (see Figure 2).

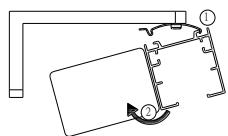

Figure 1

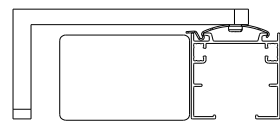
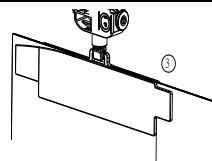
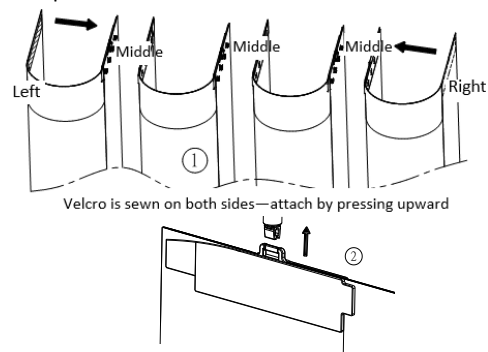

Figure 2

Installing the Fabric Vanes

Install the fabric vanes in order from left to right (front-facing). Use solid fabric clips on the outer edges and slotted clips for the inner vanes. To assemble slotted clips, align the notched and tabbed sides through the fabric holes, then insert the completed clips into the fabric hooks to complete the installation.



Removal

- Remove the fabric vanes

To remove the fabric vanes, start from the right side (front-facing), pull the fabric clip downward from the hook (see Figure 1), then gently pry open the clip from both sides to detach it from the fabric (see Figure 2).

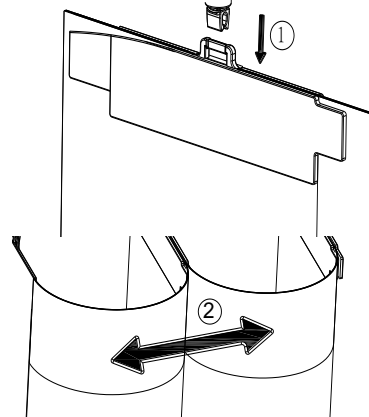

- Remove the headrail
First detach the motor as below

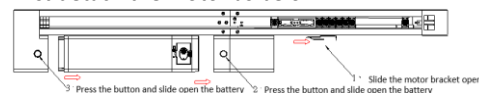

Then use a flathead screwdriver to push upward on the rear lower edge of the mounting bracket (see Figure 1) to disengage the rear flange of the headrail from the slot, and finally rotate the headrail forward from back to front to complete removal (see Figure 2).

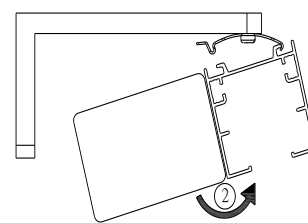
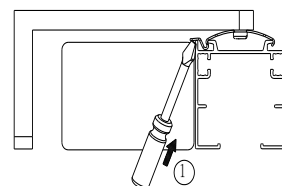

Remote Button Definitions

Function	Operate	Basic Remote
Stop	Press	
Fully- Opened (Fabric Stack)	Press	
Fully- Closed (Fabric Expand)	Press	
Rotate the vanes left 15 degrees	Short Press	
Rotate the vanes left to 0 degrees	Long Press	
Rotate the vanes right 15 degrees	Short Press	
Rotate the vanes right to 180 degrees	Long Press	
Fully- Opened (Best View)	Press	
Fully- Closed (Best Privacy)	Press	
My favorite	Press	

Trouble Shooting

Problem	Possible Cause	Description
No reaction upon operation	Low battery of Remote	Please check if the remote group lights work normally, or replace new batteries.
	Low battery of Shade with Battery Motor	Please charge the shade with charging kit that ordered with the shade or with your own USB-C charger.
	Overtime Protection	The shade will be under overtime protection when five minutes of non-stop continuous operation is under the same command. This status will be lifted after the motor stops for 1 sec.
The shade is not paired with the Remote		Press the paired Group button and check if the shade responds. Shade response as shift x 1 means it has been paired. Shade no response means it needs to be paired first. Please refer to "remote control manual" for pair steps.
The limits are not fully setup.		Press on remote to operate the shade and check if the shade works normally. If not, the shade limits might not be fully set up. Please refer to "remote control manual" to set up shade limits again.
Other Problems		Re-power ON : Press the shade button for 3 seconds to power ON/OFF the shade. If the problem still exists, please contact your customer service for further assistance.

Limits shift	Abnormal power failure	Abnormal power failure may cause a shift of limits, please refer to "Remote Control Manual" to set up limits again.
	Other Problems	Please contact your customer service for further assistance.

Safety Instructions for Lithium Batteries

DANGER

Do not immerse the battery in any liquid, such as water, beverages, or other fluids. Exposure to liquid may damage the battery or the battery pack. Damaging the battery may overheat and pose a fire or explosion risk.

Do not use or place the battery in or near an open flame, heater or high temperature areas, such as those near a microwave or other cooking appliance. Subjecting the battery to high temperature or near electromagnetic radiation may damage the polyolefin separator and can cause short circuit. This may cause the battery to overheat and pose a fire or explosion risk.

Do not attach or insert battery with polarity reversed. If the battery does not easily fit into the charger or device, check the battery orientation. Do not force the battery into the compartment. If the battery is inserted incorrectly, the battery may overheat and pose a fire or explosion risk.

Do not use the battery in equipment for which it was not intended. If the battery is used in unapproved applications or systems, the battery may be damaged and overheat and pose a fire or explosion risk.

Do not connect the positive (+) and negative (-) terminals with a conductive material. Do not carry or store the battery with any metal objects. If the battery is shorted, it may overheat and the battery may overheat and pose a fire or explosion risk.

Avoid excessive impact to the battery. Impact beyond specification may damage the battery. This may cause the battery to leak, overheat and pose a fire or explosion risk. Do not penetrate

the battery with any sharp object. If subjected to a hard strike or penetrated by an object, the battery may be damaged, thereby causing the battery to short-circuit. This may cause the battery to overheat and pose a fire or explosion risk.

Do not directly solder to the battery. Soldering directly to the battery could melt the separator, damage the fume release vent or other safety mechanisms. This may cause the battery to overheat and pose a fire or explosion risk.

Do not disassemble the battery. Disassembly or modification of the battery may damage the protection circuit. This may cause the battery to overheat and pose a fire or explosion risk.

Do not charge the battery near high temperature. If the battery is charged while exposed to high temperature, the battery's protection circuit may activate and prevent charging, or fail and cause the battery to overheat and pose a fire or explosion risk.

WARNING

Keep away from small children Keep the battery away from small children. If the battery or any of its component parts is swallowed, seek medical attention immediately.

Mixed Use Do not mix with other batteries. The battery should not be used with other batteries having a different capacity, chemistry, or manufacturer. Doing so could cause the battery to overheat and pose a fire or explosion risk.

Rust, Discoloration and Deformities Do not use abnormal batteries. Immediately stop using the battery if there are noticeable abnormalities, such as smell, heat, discoloration, or deformity. The battery may be defective and could overheat and pose a fire or explosion risk with continued use.

Charging Time Stop charging if the charging process cannot be finished. If the battery cannot finish the charging process within the specified time, halt the charging process. The battery may overheat and pose a fire or explosion risk.

Leakage -1 Do not use a leaking battery near open flame. If the battery or liquid leaking from the battery has an irritating odor, the battery should be kept away from any open flame. If exposed to an open flame, the battery could

ignite and explode.

Leakage -2 Do not touch a leaking battery. If liquid leaking from the battery gets into your eyes or makes contact with your skin, immediately flush your eyes or skin with clean water and seek medical attention. If left untreated, it will cause significant eye or skin damage.

Transport Pack the battery securely for transport. To prevent short-circuit or damage during transport, securely pack the battery in a case or carton.

CAUTION

Exposure to Direct Sunlight Do not use or leave the battery in a location exposed to excessive heat, such as in direct sunlight or in a car. Doing so could cause the battery to overheat and pose a fire or explosion risk. It may also cause the battery's performance and life to deteriorate. Use with other Equipment or Power The battery pack has a protection circuit. Do not use the battery with other equipment or power as it may damage the protection circuit. If the protection circuit fails, the battery may overheat and pose a fire or explosion risk.

Charging Temperature Range Only charge the battery between 0°C and 45°C. Charging outside of this temperature range may cause the battery to leak, generate heat, or result in serious damage. It may also cause the battery's performance and life to deteriorate.

Charging Method Read the user's manual for proper product charging method.

First Time Usage Please contact the supplier if the battery gives off an unusual odor, generates heat, or shows signs of rust prior to its initial use.

Flammable Materials Do not charge or discharge near flammable materials. Doing so could result in fire.

Handling of Exposed Contacts or Conductors If the battery pack has a system interface consisting of stripped lead wires or exposed contact plates, handle with due care.

Temporarily insulate exposed contacts and conductors with an insulator such as polypropylene tape or polyvinylchloride tape. Failure to do so could result in an electrical

shock; a short circuit causing the battery to overheat and pose a fire or explosion risk; or the combustion of other materials.

Recycling When disposing of the battery, recycle it according to local rules and regulations.

N301084-D