

SHEER SHADE INSTALLATION INSTRUCTION

SUGGESTED TOOLS (not included)



BEFORE YOU BEGIN YOUR INSTALLATION

Your new Sheerview 2", 2.5" and 3" is custom made to your specifications from the finest material available. The installation should be easy and your blind will look elegant.

Mounting Options

- **Inside mount:** Blind is mounted inside the window frame, either to the top of the frame or to the sides.
- **Outside mount:** Blind is mounted either on or outside the window frame.
- **Note:** Mounting screws provided are suitable for most mounting surfaces. See below for additional suggestions.
- For wallboard or plaster: Use hollow wall anchors for added support.
- For concrete, stone, brick or tile: Use an appropriate drill and appropriate anchors before fastening the screws.
- For metal surfaces: Pre-drill holes and use appropriate anchors before fastening the screws.

PARTS

Clip Brackets Quantity: 2

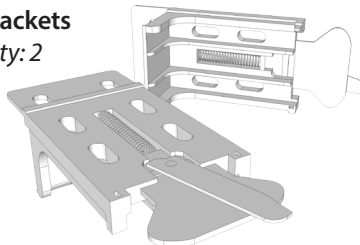

Screws Quantity: 8 per packet

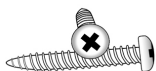

OPTIONAL PARTS

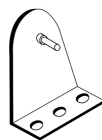

Hold Down Bracket
To hold the bottom rail of the blind in place i.e. for a door window

1 Mounting brackets

- Using 4 screws per box bracket, fasten the brackets to the mounting surface. Always use 4 screws. Brackets come in the open position one you have snapped your Sheerview blind in to place the brackets will lock the blinds in to place.
- **NOTE:** There is a snap off shim piece at the back of the bracket which can be used to level the blind.

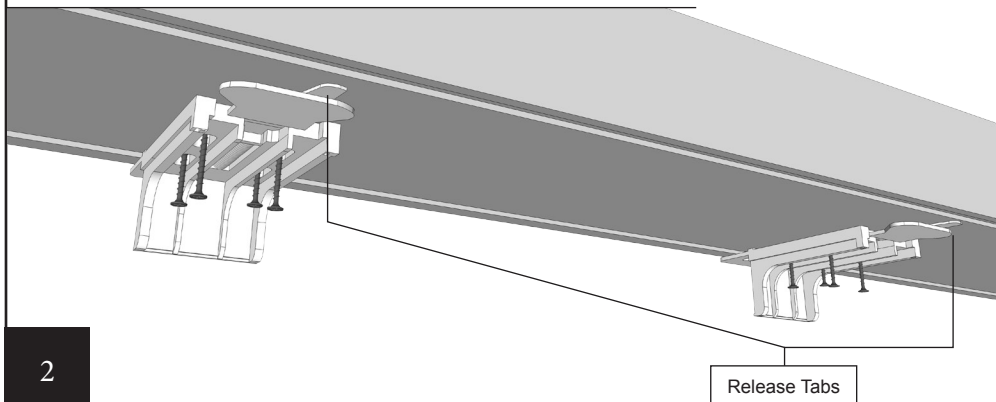

2

Installing the blind into the brackets

- The clips should align to the metal channel on the back of the upper headrail / valance.
- Make sure the blind is in the closed position to make this step easier. Fit the headrail into the brackets (1) when you hear a snap and it feels secure to the touch you have successfully installed the Sheerview blind to the brackets.

Back of the Blind

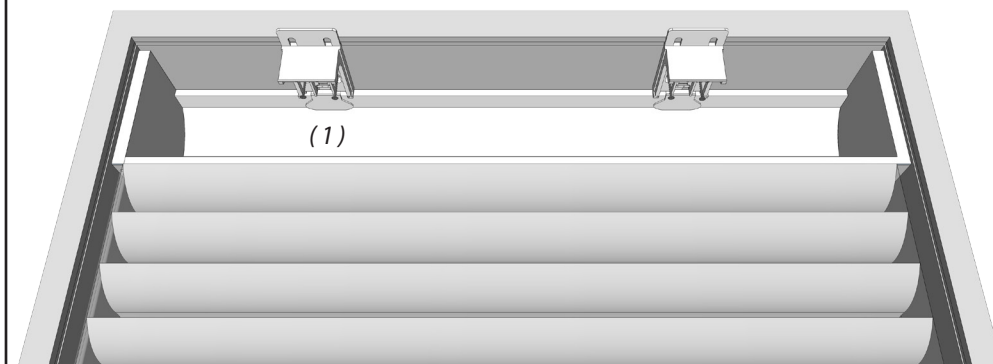

3

Release Sheerview Blind

- To release the sheer view blind for cleaning or to replace use tabs to detach the headrail from the mounting brackets.

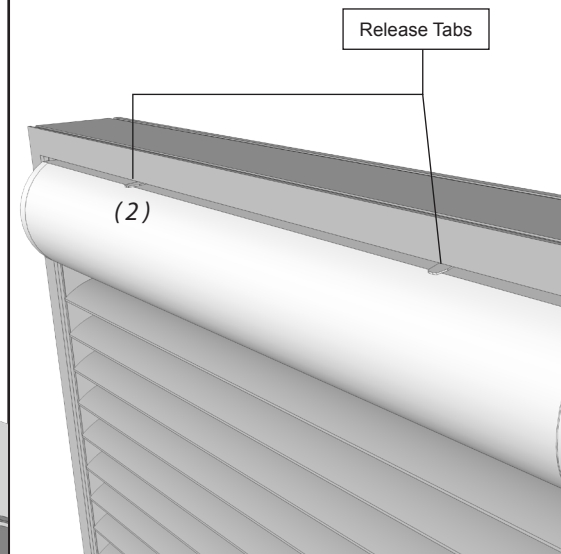

Alternate Views

- Fig. 1: Geometric view of blind from right side.
- Fig. 2: Clearance from frame to top of headrail.

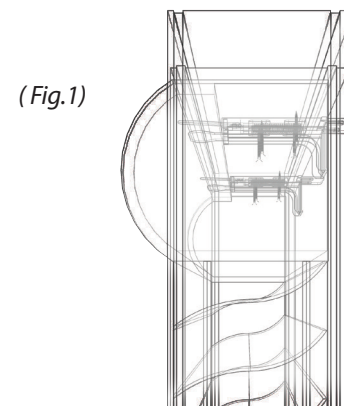

4

Installing the child safety tension device

- Dangling or accessible cords on window coverings can pose an accidental strangulation hazard to infants and young children. It is required that the child safety tension device be installed to remove slack from cords. Install tension device on the window frame to remove all slack on the drawstring cord.
- (see Fig 3.) attach to wall/window frame via screw
- (see Fig 4.) not attached to the window frame, locks drawstring from continual use

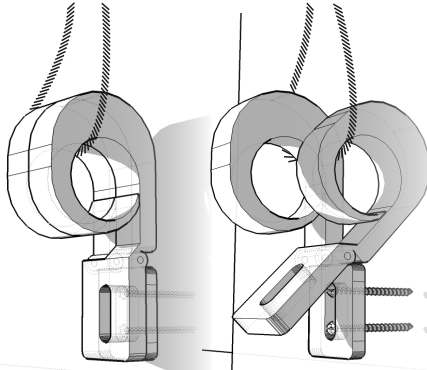

(Fig. 3)

(Fig. 4)

5

Installing hold down brackets

(only if you have ordered hold down brackets)

- Lower the blind to the desired height.
- Position the hold down bracket to align the tab.
- Mount the bracket using the two screws provided (see Fig. H). Insert the tab into the pre-drilled hole. To raise or lower the blind, release the bottom rail from the brackets by pulling the brackets away from the bottom rail.

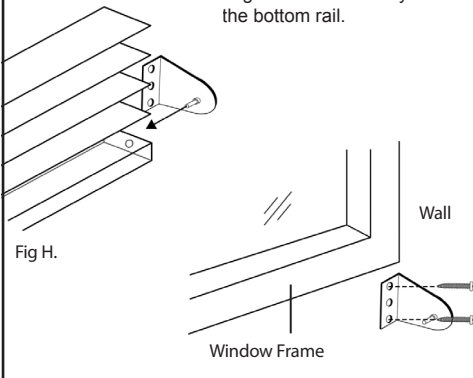

Fig H.

! WARNING

Young children can **STRANGLE** in cord and bead chain loops and in the loop(s) above the cord connector. They can also wrap cords around their necks and **STRANGLE**.



- Always keep cords and bead chains out of children's reach.
- Move cribs, playpens, and other furniture away from cords and bead chains. Children can climb furniture to get to cords.

CHOKING HAZARD

- Keep cord out of reach from children.
- Remove objects below window.
- Do not tie cords together.
- Make sure safety cords are located 1-2 inches below the head-rail.
- Please reference all warning tags in the instructions and on the blind.
- Please keep cords out of children's reach use one of the devices available at hardware or window covering stores.



Emergency First Aid for Strangulation



- Remove cord from child's neck
- Call 911 or emergency Center
- Clear throat
- Check breathing and heartbeat
- Begin CPR

LIMITED LIFETIME WARRANTY

The Lantex Collection will be free from defects in materials and workmanship for as long as the original purchaser owns the product, provided that the product was installed properly. The limited lifetime warranty is extended to the original purchaser only, in the original window for which it was intended.

The warranty does not include any condition or damage resulting from accidents, alterations, misuse, failure to install properly, or others instances outside of Lantex's control. This warranty also does not apply to conditions resulting from normal wear and tear.

To obtain service, contact the dealer from whom you purchased the product. Lantex will repair or replace defective parts or components at no charge.

This warranty is exclusive and in lieu of all other obligations, liabilities or warranties. In no event shall Lantex be liable for incidental or consequential damages, or for any other damage, loss or expense, cost or fees associated with such damage. In some states, exclusion for incidental or consequential damages are not allowable.

This warranty does not cover any transport, removal, or re-installation charges which may occur as a result of defects in materials or workmanship.

This warranty gives you specific legal rights, and may also have other rights, which vary from state to state.



Thank you for choosing our Sheerview Horizontal Blind for your Home.

We are confident that you will find these window blinds to be of superior quality and value, compared to other blinds on the market today.

In this guide, you will find useful information about installation, child safety, cleaning and warranty when using our blinds.

Read all installation instructions before installation

CARE & CLEANING

The soft, delicate feel of the fabric belies the durability of the material. It is made from a sturdy, knitted polyester fabric which can be feather dusted or vacuumed on a low setting. Spots or stains can be lightly rubbed clean with a damp sponge and mild soap. To avoid discoloration of the material, we recommend against the use of chemical cleaners. The sheer fabric may also be ultrasonically cleaned.

IMPORTANT SAFETY WARNING

Window cords can pose a potential strangulation hazard to young children. According to the U.S. Consumer Product Safety Commission, corded window coverings are among the top five hidden hazards in American homes. Check your window coverings for exposed or dangling cords and retrofit or replace them with today's safer products.

Never place a crib, playpen, bed or any type of low-standing furniture near a window. In exploring their surroundings, young children can accidentally fall through an open window or window screen, or become tragically entangled in a nearby window cord. Whenever possible, place cribs and furniture on a non-windowed wall.

Dangling or accessible cords on window coverings can pose an accidental strangulation hazard to infants and young children. For your safety, replace older corded window coverings with today's safer products.

The Window Covering Safety Council (WCSC) and government safety officials recommend that you only use cordless window products in homes with young children.

! WARNING

Young children can **STRANGLE** in cord and bead chain loops and in the loop(s) above the cord connector. They can also wrap cords around their necks and **STRANGLE**.



- Always keep cords and bead chains out of children's reach.
- Move cribs, playpens, and other furniture away from cords and bead chains. Children can climb furniture to get to cords.