

1" Cordless Aluminum Blind Installation and User Guide

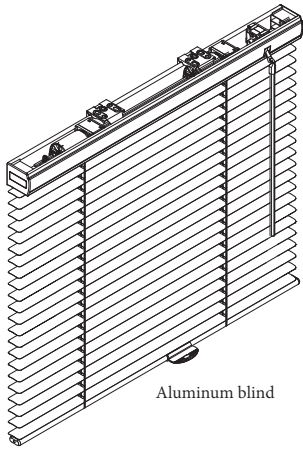

1. Identify your aluminum blind and parts (your parts may vary, depending on the custom request & size of the blind you are purchasing.)

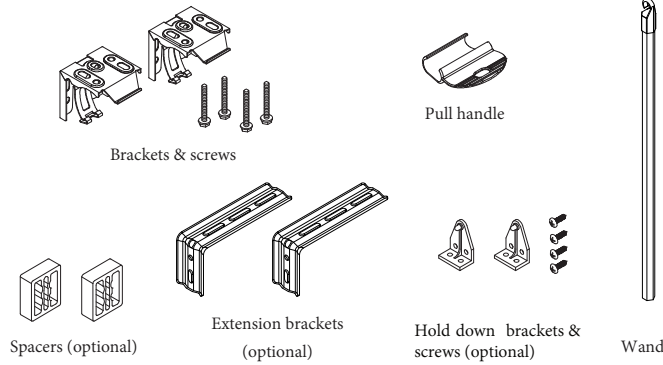

2. Tools you may need (not included)

- Drill with bits
- Metal tape measure
- Screwdriver
- Pen

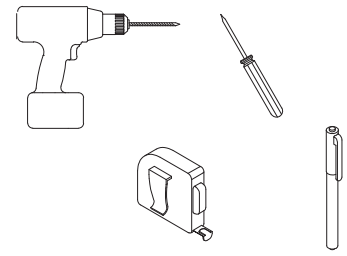

3. Install the brackets

- Mark the bracket locations, making sure the brackets will not interfere with any mechanism or other internal headrail parts. The outermost brackets should be installed close to each headrail end cap. If you have more than 2 hidden brackets, install all remaining brackets towards the center of the headrail evenly.
- Install the brackets using screws (included) and tighten them completely.
- Make sure all brackets are aligned and level with each other.

- Install the blind with extension brackets (optional)

- Install the extension bracket with at least 2 screws.
- Attach the hidden brackets to the extension brackets with the screws.

Optional - Add a spacer behind the bracket if needed.

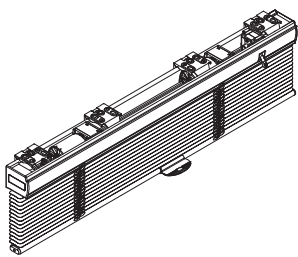

Inside Mount

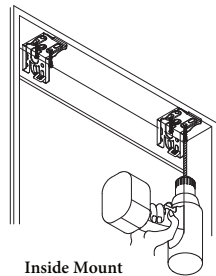

Outside Mount

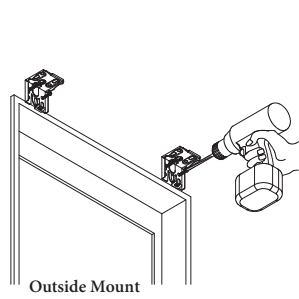

Extension bracket

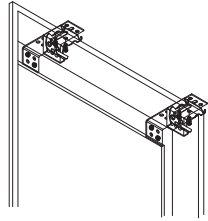
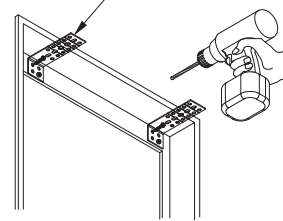

4. Attach the blind

- Position the headrail with the front lip resting on the top hooks of all the brackets.
- Push the bottom of headrail firmly upward and toward the window until the groove at the bottom of the headrail snaps into place.

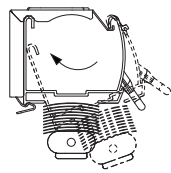
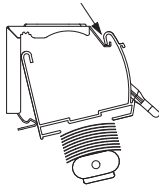

5A. How to remove the blind from the brackets

- Unlock the hidden brackets with a flat head screwdriver.

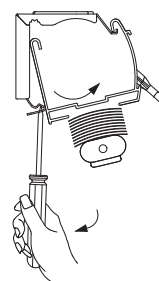
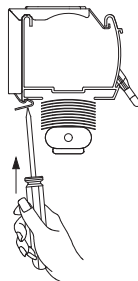

6. Attach the tilt wand

- Attach the tilt wand onto the wand hook located on the headrail.

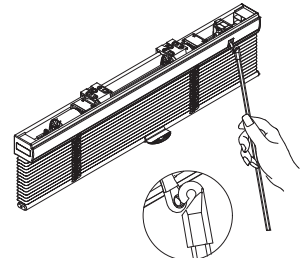

7. Use hold down brackets to keep the bottom rail in a fixed position (optional)

- A hold down bracket secures a blind's bottom rail to the bottom of a door or window to prevent it from moving. These are usually only needed when installing blinds on doors and in RVs to help to prevent damage to your blinds, doors, and windows.
- The hold down bracket shall be installed to the wall when it is an outside mount or to the jamb of the window frame when it is an inside mount. Do not install hold down brackets on the sill of the window frame.
- Fully lower the blind and insert the hold down bracket pin into the hole at the side of the bottom rail end-cap, one hold down bracket per each end cap, then mark the location of each hold down bracket.
- Each hold down bracket should be secured with two screws.
- Place the hold down bracket pins into the end caps of the bottom rail to secure the bottom rail in place.

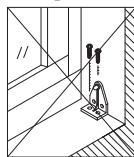
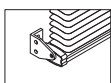
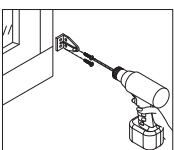

8. Care and Clean

- Wipe the blind periodically with a soft dust cloth or dusting mitt, or vacuum with a soft brush attachment.
- You may clean the blinds using a non-scratched sponge or dampened soft cloth with a mild nonabrasive detergent. Never use hot water, solvents, or harsh or abrasive cleansers to clean the blinds.
- Note: The warranty for your blinds does not cover damage caused by improper cleaning.

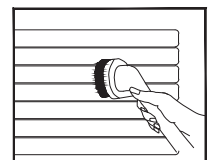
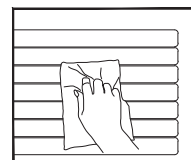

Simple Touch® Motorized Aluminum Blind

Installation

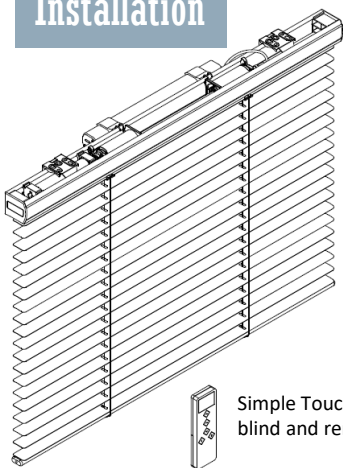

Simple Touch aluminum blind and remote

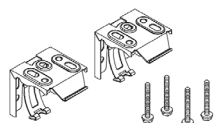

Brackets & screws

blind width	Qty of brackets
$W \leq 39.5"$	2
$39.5" < W \leq 67"$	3
$67" < W \leq 96"$	4
$96" < W \leq 120"$	5



Rechargeable battery pack (*The default quantity of the charger and USB cord is 1 set per order. You can request more sets at no cost up to the same quantity as the rechargeable battery pack you ordered.)

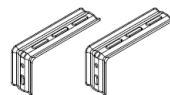

Extension brackets (optional)

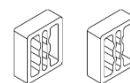

Spacers (optional)

Tools you may need (not included)

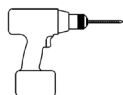

Drill with bits



Metal tape measure



Pen



#4 x 3/4" flat head wood screw



Screwdriver

Install the brackets

- Mark the bracket locations. Space the brackets evenly and make sure the brackets will not interfere with any mechanism or other internal headrail parts.
- Install the brackets using screws (included) and tighten them completely.
- Make sure all brackets are aligned and level with each other.

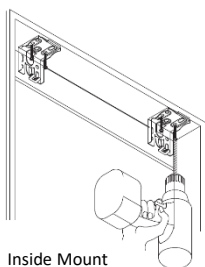

Inside Mount

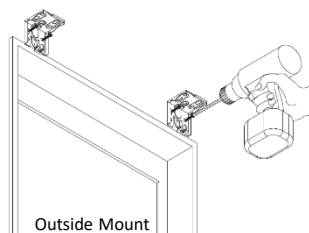

Outside Mount

- Install the blind with extension brackets (optional)
 - Install the extension bracket with at least 2 screws.
 - Attach the hidden brackets to the extension brackets with the screws.

Extension bracket

Optional – Add a spacer behind the bracket if needed.

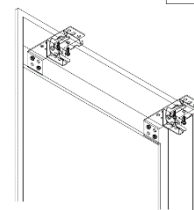
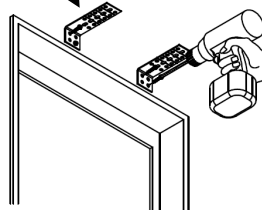

Install the rechargeable battery pack

- The rechargeable battery pack can either be hooked behind the headrail or mounted to the wall or window frame.
- Refer to the Simple Touch rechargeable battery pack user guide to install the battery pack.

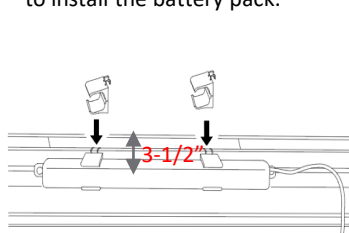

The minimum flush mounting space is 3-1/2" ~4".

or

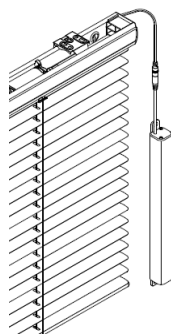

Attach the blind

- Position the headrail with the front lip resting on the top hooks of all the brackets.
- Push the bottom of headrail firmly upward and toward the window until the groove at the bottom of the headrail snaps into place.

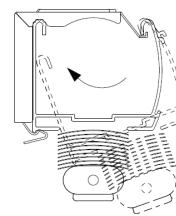
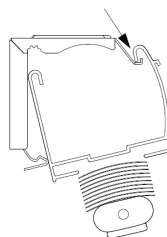

How to remove the blind from the brackets

- Press the **UP** button to raise the blind completely.
- Use a flat screw to push the bracket tab toward to the wall. Once you hear a “click”, then the blind will be released from the bracket.
- Repeat above step to release the blind from other brackets.

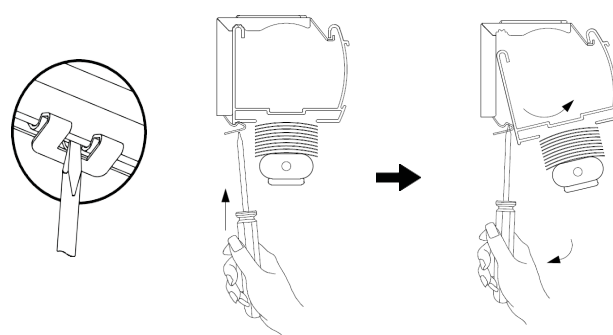

Programming Guide for the Simple Touch Aluminum Blind

No programming needed. We have programmed your blind.
The programming steps below are optional.

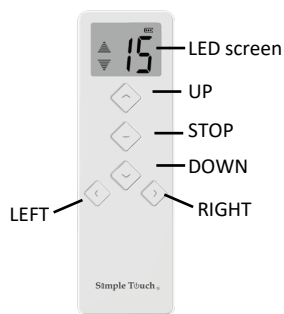
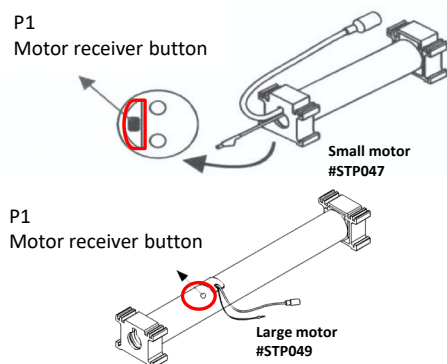

Front side of the remote

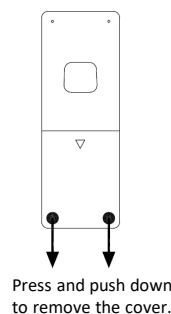

Back side of the remote

- The default group control is on channel #0.
- Option to set up “MY FAVORITE POSITION” if you prefer, simply follow the instructions below. Once you have set it up, you will be able to quickly access your preferred position with just the press of the STOP button.
- Recharge the rechargeable battery pack doesn’t affect the setting of the blinds.

Optional Programming Instructions

PROGRAMMING FOR MY FAVORITE POSITION

Set Up My Favorite Position

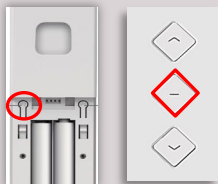

- Step 1. Click the **LEFT** or **Right** buttons to select the channel you wish to program.
- Step 2. Raise the blind all the way up by clicking the **UP** button. Skip this step if the blind is already at the top position.
- Step 3. Adjust the bottom rail to your favorite height by clicking the **DOWN** or **UP** buttons, and then hit the **STOP** button.
- Step 4. Click either one of the **P2** buttons. The blind jogs once. **JOG x 1**
- Step 5. Click the **STOP** button once. The blind jogs once. **JOG x 1**
- Step 6. Click the **STOP** button again. The blind jogs twice. **JOG x 2**
- My favorite position set up is done.**

Remove My Favorite Position

- Step 1. Click either one of the **P2** buttons. The blind jogs once. **JOG x 1**
- Step 2. Click the **STOP** button once. The blind jogs once. **JOG x 1**
- Step 3. Click the **STOP** button again. The blind jogs once. **JOG x 1**
- Remove My Favorite Position is done.**

ADJUST THE TOP LIMIT

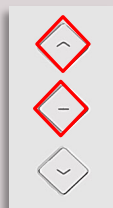

Step 1. Click the **LEFT** or **Right** buttons to select the channel you wish to program.

Step 1. Press the **STOP** and **UP** buttons for about 5 seconds until the blind jogs once.

JOG x 1

Step 2. Use the remote to control the blind to the desired upper position and then hit the **STOP** button.

Step 3. Press the **STOP** and **UP** buttons for about 2-3 seconds until the blind jogs twice.

JOG x 2

Adjust the top limit is done.

ADJUST THE BOTTOM LIMIT to fit your window height

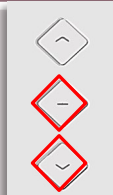

Step 1. Press the **STOP** and **DOWN** buttons for about 5 seconds until the blind jogs once.

JOG x 1

Step 2. Use the remote to control the bottom rail to fit your window height and then hit the **STOP** button.

Step 3. Press the **STOP** and **DOWN** buttons for about 2-3 seconds until the blind jogs twice.

JOG x 2

Adjust the bottom limit is done.

ADD/ REMOVE A DUPLICATED REMOTE CONTROL

ADD



Step 1. Select the channel you wish to copy by clicking the **LEFT** or **RIGHT** buttons on both **EXISTING** and **NEW** remotes.

Step 2. Click one of the **P2** buttons once on the existing remote. The blind jogs once.

JOG x 1

Step 3. Click the same **P2** button again. The blind jog once.

JOG x 1

Step 4. Click one of the **P2** buttons on the new remote. The blind jogs twice.

JOG x 2

REMOVE

Process the step 1 to 4 above to remove the remote.

LOCK/ UNLOCK 3 FRONT BUTTONS to prevent resetting the top and bottom limits

LOCK

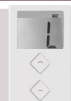

Step 1. Press and hold the **STOP** button until “L” shown on the screen (about 15-20 seconds).

Step 2. Click **P2** button once, then the “half 0” symbol will be shown on the screen. **The lock setup** is done.

UNLOCK



Step 1. Press and hold the **STOP** button until “U” shown on the screen (about 15-20 seconds).

Step 2. Click **P2** button once, then the “half 0” symbol will be shown on the screen. **The unlock setup** is done.

ADJUST THE MOTOR SPEED (Three speeds are available. The slowest speed is the default setting)

ACCELERATE

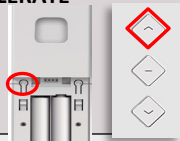

Step 1. Click one of the **P2** buttons once. The blind jogs once.

JOG x 1

Step 2. Click the **UP** button. The blind jogs once.

JOG x 1

Step 3. Click the **UP** button again. The blind jogs twice.

JOG x 2

DECELERATE



Step 1. Click one of the **P2** buttons once. The blind jogs once.

JOG x 1

Step 2. Click the **DOWN** button. The blind jogs once.

JOG x 1

Step 3. Click the **DOWN** button again. The blind jogs twice.

JOG x 2

REVERSE THE MOTOR DIRECTION

P1 motor receiver button



Step 1. Press the **P1** button on the blind you wish to program until the blind jogs 3 times (about 10 seconds). The location of the P1 button can be found on page 1.

JOG x 3

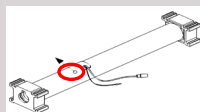

NOTE. The **P1** button is on the **side of the small motor** or on the **top of the larger motor**. Refer to page 1 for the P1 locations.

Warning: In the rare instance that you may have to do a “FACTORY RESET”, follow the sequence and steps below. Complete to program “PAIR THE REMOTE TO THE BLIND”, “SET UP THE TOP LIMIT”, “SET UP THE BOTTOM LIMIT”, and “SET UP THE MOTOR TO JOG MODE” before operating the motorized blind again.

FACTORY RESET

P1 motor receiver button

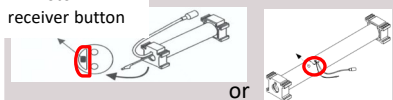

Step 1. Press the **P1** button on the motor you wish to reset until the blind jogs 4 times (about 15 seconds). **JOG x 4**

Note. DO NOT RELEASE the **P1** button during this step. If accidentally release it, please must redo it again. Different numbers of jogs will result in different settings.

PAIR THE REMOTE TO THE blind

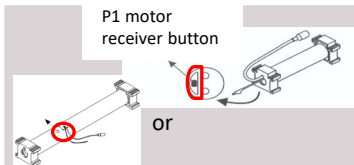

Step 1. Press the **P1** button on the same blind about 2-3 seconds. The blind jogs once. **JOG x 1**

Step 2. Select the channel on the remote.

Step 3. Press the **STOP** button on the remote for about 2-3 seconds. The blind jogs twice. **JOG x 2**
Make sure you stay at the same channel.

SET UP THE TOP LIMIT

TOP Limit



Step 1. Press the **UP** button to move the blind up, then hit the **STOP** button when it reaches the top.

Step 2. Press both **UP** and **STOP** buttons for about 2-3 seconds. The blind jogs twice. **JOG x 2**

SET UP THE BOTTOM LIMIT

Bottom Limit



Step 1. Press the **DOWN** button to move the blind down, then hit the **STOP** button when it reaches the bottom.

NOTE: The setup will not succeed when the **STOP** button is pressed after the bottom rail passes through the bottom and then travels up. If it accidentally happened, start it again by pressing the **UP** button to raise the blind and repeat **Step 1**.

Step 2. Press both **DOWN** and **STOP** buttons for about 2-3 seconds. The blind jogs twice. **JOG x 2**

SET UP THE MOTOR TO JOG MODE (The jog mode allows you to tilt the slats by clicking the UP or DOWN button.)

Jog mode

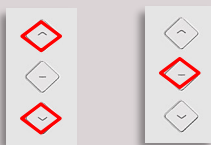

Step 1. Press both **UP** and **DOWN** buttons for about 5 seconds. The blind jogs once. **JOG x 1**

Step 2. Click the **STOP** button. The blind jogs once. **JOG x 1**

Note. The default mode of the motor is the continuous mode. Switch to jog mode will allows you to tile the slats by clicking the UP or DOWN button.

Continuous Mode

Repeat step 1 and step 2 above to switch the motor back to continuous mode.

Care and Clean

- Wipe the blind periodically with a soft dust cloth or dusting mitt, or vacuum with a lowest speed.

Notes

- Do not spill water to the headrail and the wand.
- Do not clean or operate the motorized blind with wet hands
- The warranty of your blinds does not cover damage caused by improper cleaning.
- The motorized blind is for indoor use only.
- Do not use the motorized blinds at the wet area.

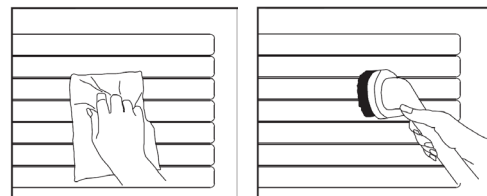

FCC ID
#2AWSE-STP054

FOR INDOOR USE ONLY

This motorized blind has been tested and found to complete with the limits for a Class B digital device, pursuant to part 15 of the FCC rules. These limits are designed to provide reasonable protection against harmful interference in a residential installation. This blind generates, uses and can radiate radio-frequency energy. If this blind is not installed and used in accordance with the instructions, it may cause harmful interference to radio communications. However, there is no guarantee that interference will not occur in a particular installation. If this blind does cause harmful interference to radio or television reception, which can be determined by turning the blind off and on, correct the interference by one or more of the following measures:

- Reorient or relocate the receiving antenna.
- Increase separation between blind and receiver.
- Connect equipment to an outlet on a circuit different from that to which the receiver is located.
- Consult your dealer or an experienced radio/TV technician.

Any changes or modifications to the product that are not expressly approved by HT could void the user's authority to operate this blind. Use of a shielded interface cable is required to comply with the Class B limits of Part 15 of FCC rules. For more regulatory information, see the electronic user guide. HT shall not be liable for any direct, indirect, incidental, consequential, or other damage alleged in connection with the furnishing or use of this information.

FOR INDOOR USE ONLY

Simple Touch® Wand Aluminum Blind User Guide

Installation

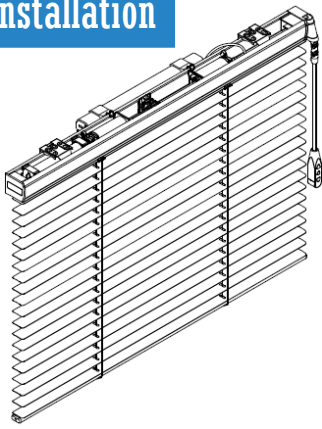

Simple Touch Wand
Motorized aluminum blind

Identify your aluminum blind and parts (your parts may vary, depending on the custom request, size of the headrail & blind you are purchasing.)

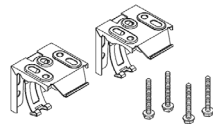

Brackets & screws

blind width	Qty of brackets
$W \leq 36"$	2
$36" < W \leq 48"$	3
$48" < W \leq 72"$	3
$72" < W \leq 96"$	4
$96" < W \leq 120"$	5



Rechargeable battery pack (*The default quantity of the charger and USB cord is 1 set per order. You can request more sets at no cost up to the same quantity as the rechargeable battery pack you ordered.)

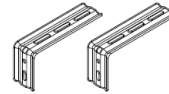

Extension brackets (optional)

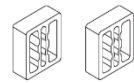

Spacers (optional)

Tools you may need (not included)

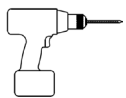

Drill with bits



Metal tape measure



Pen



#4 x 3/4" flat
head wood screw



Screwdriver

Install the brackets

- Mark the bracket locations. Space the brackets evenly and make sure the brackets will not interfere with any mechanism or other internal headrail parts.
- Install the brackets using screws (included) and tighten them completely.
- Make sure all brackets are aligned and level with each other.
- Install the blind with extension brackets (optional)
 - Install the extension bracket with at least 2 screws.
 - Attach the hidden brackets to the extension brackets with the screws.

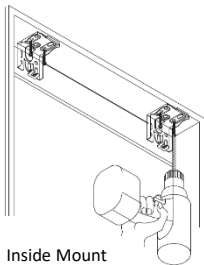

Inside Mount

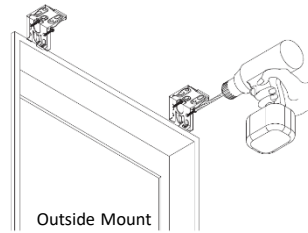

Outside Mount

Extension bracket

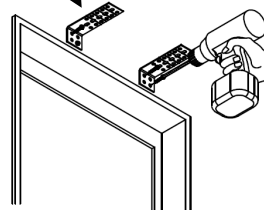

Optional – Add a spacer behind the bracket if needed.

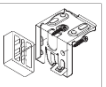

Install the rechargeable battery pack

- The rechargeable battery pack can either be hooked behind the headrail or mounted to the wall or window frame.
- Refer to the Simple Touch rechargeable battery pack user guide to install the battery pack.

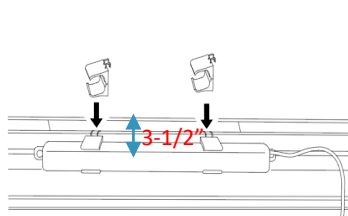

The minimum flush mounting space is 3-1/2" ~ 4".

or

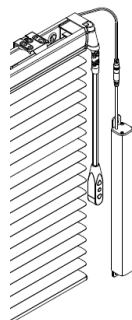

Attach the blind

- Position the headrail with the front lip resting on the top hooks of all the brackets.
- Push the bottom of headrail firmly upward and toward the window until the groove at the bottom of the headrail snaps into place.

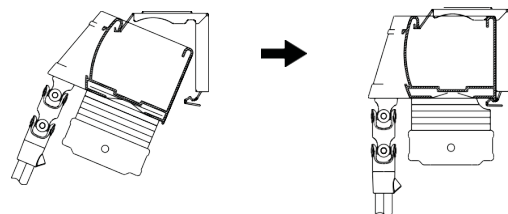

How to remove the blind from the brackets

- Press the **UP** button to raise the blind completely.
- Use a flat screw to push the bracket tab toward to the wall. Once you hear a “click”, then the blind will be released from the bracket.
- Repeat above step to release the blind from other brackets.

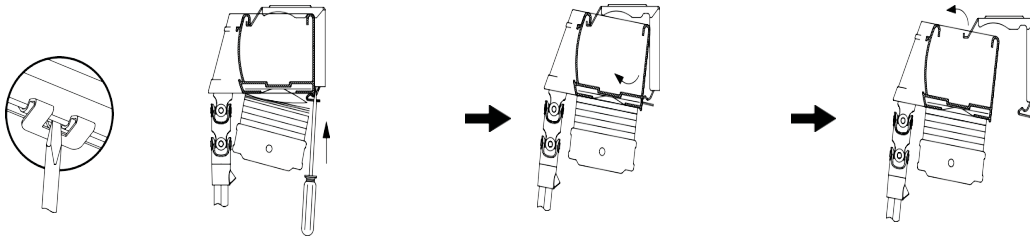

Operate the Simple Touch Wand Motorized aluminum blind

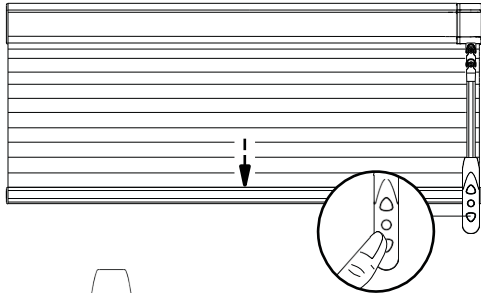

Press the **DOWN** button to lower the blind.

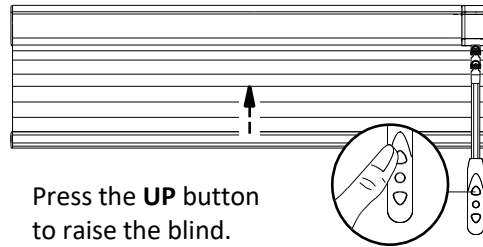

Press the **UP** button to raise the blind.



Press the **STOP/My FAVORITE** button to stop the moving.
Press and hold the **STOP/My FAVORITE** button to stop the moving



Before set up the TOP and BOTTOM limits

- The bottom rail only travels while pressing the **UP** or **DOWN** button.
- Click the **STOP** button to stop the moving.

After set up the TOP and BOTTOM limits and Before set up “MY FAVORITE POSITION”

- Press and hold the **Up** or **Down** button for about 5 seconds, the blind will travel either to the top or bottom limit without pressing the buttons
- Click the **STOP** button to stop the moving.

After set up “MY FAVORITE POSITION”

- Press and hold “**My Favorite**” button for 2-5 second, the bottom rail will travel to the Favorite position.

Care and Clean

- Wipe the blind periodically with a soft dust cloth or dusting mitt, or vacuum with a lowest speed.

Notes

- Do not spill water to the headrail and the wand.
- Do not clean or operate the motorized blind with wet hands
- The warranty of your blinds does not cover damage caused by improper cleaning.
- The motorized blind is for indoor use only.
- Do not use the motorized blinds at the wet area.

NOTE

This Simple Touch® Wand motorized blind is already programmed with the TOP and BOTTOM Limits. Option to program "My Favorite Position" followed with the instructions below. Enjoy your new motorized blind!

Set up My Favorite Position



Operate the blind to your favorite position

Press "**My Favorite**" button for 5 seconds until you hear a long "B".

Press "**My Favorite**" button again for 3 seconds, then hear 3 short "B".

Set up "**My Favorite Position**" is done.

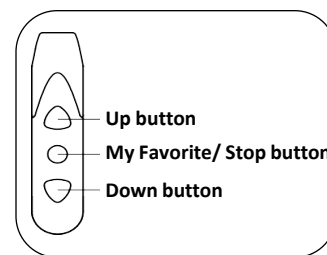
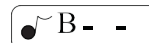

NOTE

To reprogram this motorized blind, please follow the steps below.

Set Clear



Press all 3 buttons at the same time until you hear a long "B".



"Clear" is done.

Set up the TOP Limit



Press and hold the "**UP**" button to move the blind to very top.

Press both "**UP**" & "**My Favorite**" buttons at the same time for 5 seconds until you hear 3 short "B".

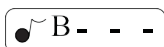

Set up the "**TOP Limit**" is done.

Set up the Bottom Limit

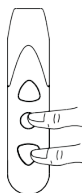

Press and hold the "**Down**" button to move the blind all the way down to the dropped height.

Press both "**Down**" & "**My Favorite**" buttons at the same time for 5 seconds until you hear 3 short "B".

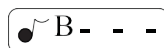

Set up the "**Bottom Limit**" is done.

To change "My Favorite Position"

- Clear all limits setting by pressing all 3 buttons at the same time until you hear a long "B".
- Follow the above programming to "**Set up the TOP Limit**", "**Set up the Bottom Limit**", and then "**Set up My Favorite Position**".



SIMPLE TOUCH RECHARGEABLE BATTERY PACK

Works with all Simple Touch Motorized Shade/ Blinds

Simple Touch motorized shades/ blinds include the following -

- Simple Touch Wand mini blinds
- Simple Touch remote regular motorized mini blinds
- Simple Touch Wand cellular Shades
- Simple Touch remote regular motorized cellular shades
- Simple Touch remote top down bottom up motorized cellular shades

PACKAGE INCLUDES

- 12V rechargeable battery pack
- 80" USB-C charge cable
- USB wall charger
- Installation brackets
- Installation screws

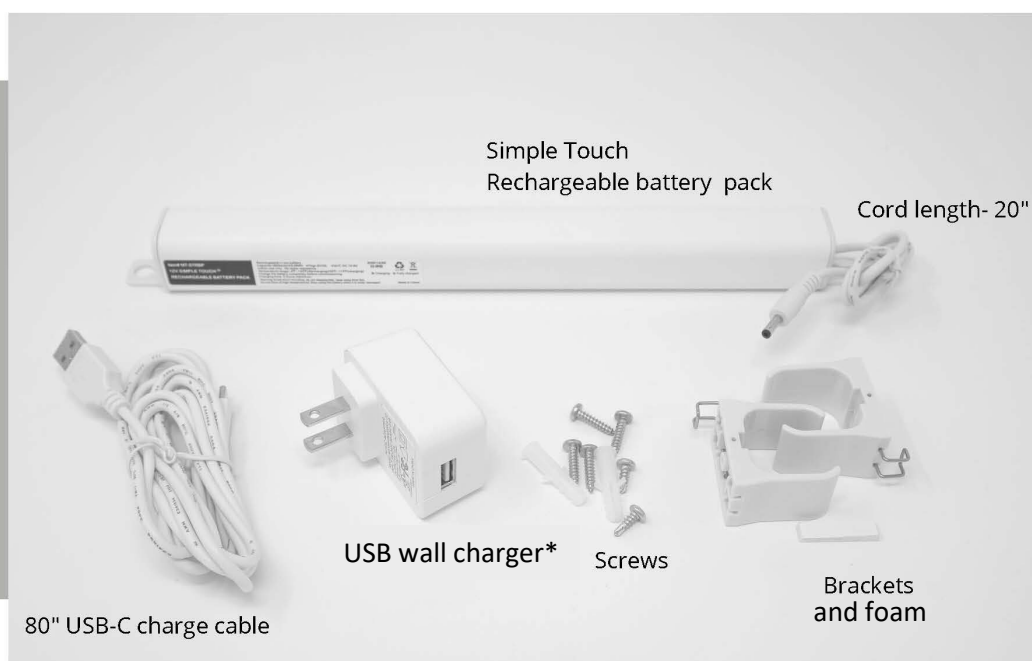

* NOTE – Do not use 3rd party USB wall charger

- Color: White
- Shell material: aluminum
- Dimensions: 10.5" x 1" x 1"
- Weight: 0.6 lbs.
- Cord length to the RF box or to the motor: 20"
- Indoor use only
- Over heat protection
- Not water resistant
- Room temperature storage
- Lifetime: more than 500 circles of charging & discharging.
- Temperature: -4°F ~140°F (discharging)
32°F ~ 113°F (charging)
- Charging time: 5 hours maximum
- Do not install it to where it may expose to the direct sunlight.

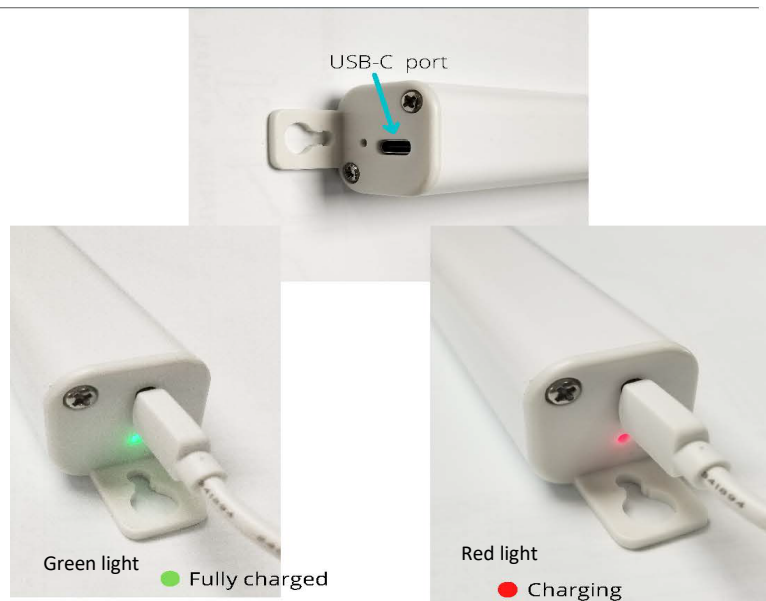

Step 1. Charge the battery completely before commissioning.

Connect the rechargeable battery pack to the USB wall charger with the USB-C charge cord. The wall charger and charging cord are inside the battery package. The indicated light will turn GREEN after the battery fully charged. It will prolong battery lifespan. Recommend unplug charger after the battery fully charged.

Note: The spare USB wall charger can be ordered from the manufacturer. To recharge the battery, use the charger recommended by the manufacturer.

Step 2. Decide the mounting location of the battery, either hook at the back side of the headrail or mount it to the wall or window frame.

Refer to the images and descriptions below to mount the battery with the brackets or directly to the wall.

Mounting option1.

Hook it at the back of the headrail



Mounting option2.

Mount it to the wall or window frame with the brackets or mounting holes



Step 3. Connect the rechargeable battery pack to the Simple Touch® motorized cellular shade or aluminum blind.



Step 4. Follow the installation instruction to install the motorized shade/ blind.

SAFETY INSTRUCTIONS

WARNING

- Please read these instructions carefully before installing and using the battery and parts.
- Incorrect installations can result in serious injury and void the warranty and liability of the manufacturer.

CAUTION

- Do not expose to humid, damp environments, or extreme temperatures.
- Do not drill, disassemble, or alter the battery or parts.
Do not drop or knock the product, expose it to flammable materials or sources of heat or moisture, or splash or submerge it.
- Do not use or install this product outdoors.
- Use or modification outside the scope of this instruction manual will void warranty
- Installation to be performed by a suitably qualified installer. The installer must inform his customers of the usage and maintenance conditions of the battery and must provide them with the user and maintenance instructions after installing the battery.
- Use only Simple Touch hardware.
- Avoid recharging the battery when nearby maintenance is being performed (for example, cleaning the windows).
- Do not install, operate, or recharge the battery with wet hands.
- Ensure you follow the instructions.
- Disable any equipment not necessary for powered operation prior to installation and remove all unnecessary cords.
- Cable routing through walls must be protected with isolating bushings or grommets.
- Ensure cables are clear and protected from moving parts.
- Do not use if any cables are damaged
- Keep batteries (new and used) and the product out of the reach of children. If the battery compartment no longer closes, do not use it.
- Keep the battery away from acid, alkali, heat & fire.
- Using the battery incorrectly can result in overheating, fire, or explosion, causing serious and even fatal injuries.

RECYCLING THE BATTERY AND ELECTRICAL COMPONENTS

Make sure the battery and electrical components are properly disposed of. Place in the specially provided containers and recycle them via your local collection facility.

!! Comply with the local regulations in force concerning the disposal of batteries.

